

•CUSTOM FABRICATION WITH .125” ALUMINUM BACKS. .090 ALUMINUM RETURNS AND .090 ALUMINUM FACES.  
OPEN FACES TO HAVE WHITE VINYL OUTLINE ON BACK OF LETTERS AND LED BULBS MOUNTED TO FALSE BACK.  
ALSO REVERSE ILLUMINATION WITH WHITE LED ON BACKSIDE OF LETTERS.

•1/2” F.C.O. PVC COPY STUD MOUNTED TO BRICK FASCIA

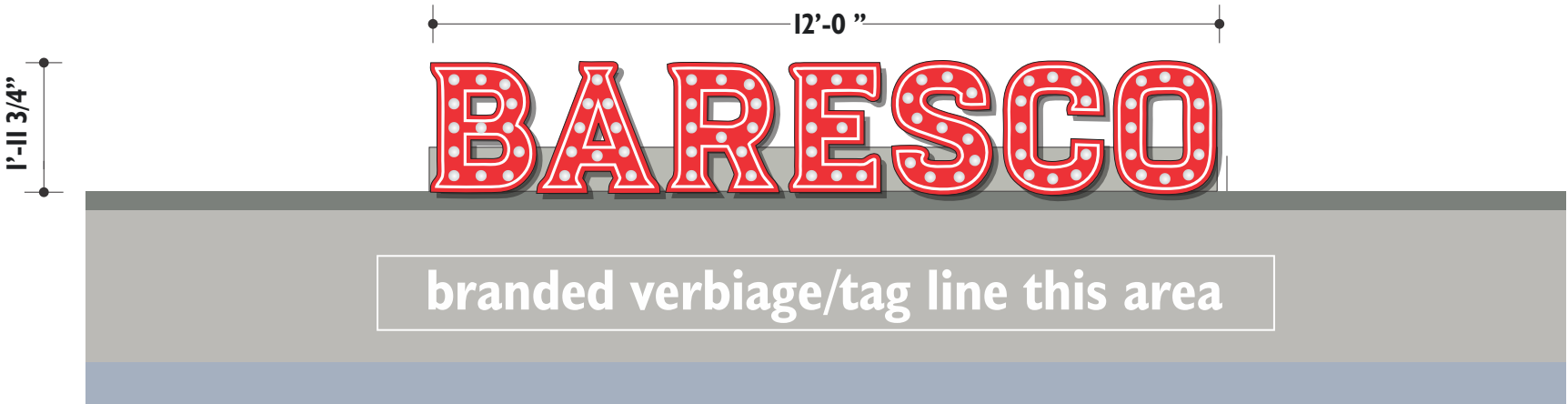
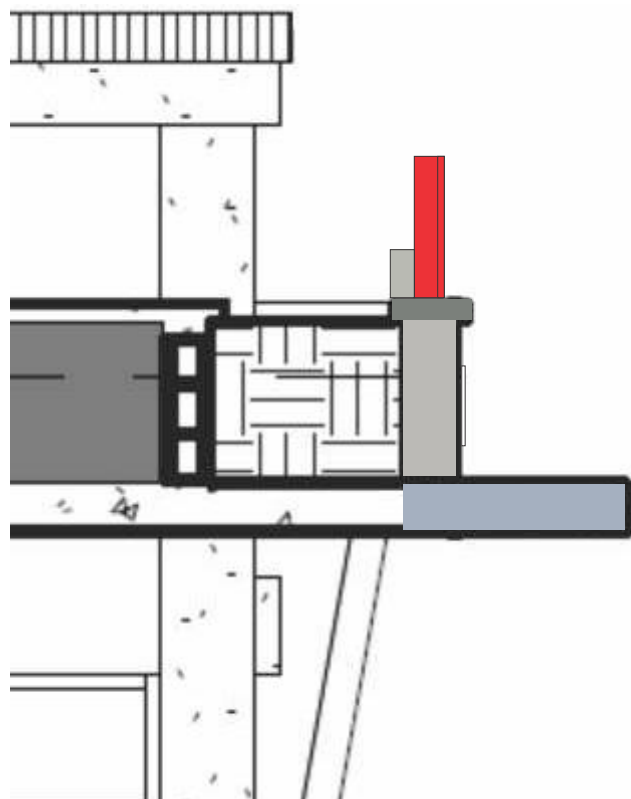

**SIGN**  
**A**  
**2**  
**OPTION**

**ELEVATION: NOTE**  
3/8" SCALE

SKETCH NUMBER	55160
JOB NAME	BARESCO
ADDRESS	POMPANO BEACH, FLORIDA
SALES	TONY MAIER
DESIGNER	R.A.LINES
DATE	08-09-21
DRAWING ID	BARESCO_55160_08-09-21

CUSTOMER APPROVAL	
SIGNED: _____	DATE: _____
PAGE 3	
10/5/2021	

LANDLORD APPROVAL	
SIGNED: _____	DATE: _____
Do not use printed drawing for exact color representation. Colors shown represent design intent only. This design and proposal are the exclusive property of A&E SIGN & LIGHTING. You may not reproduce, copy, or use this design or proposal without the express written permission of A&E SIGN & LIGHTING. Copyright © 2020 - A&E SIGN & LIGHTING	

**PROUD MEMBERS**

**OUR OFFICE**

1030 Straight St.  
Cincinnati, Oh 45214  
513-541-0024 Office  
513-541-0589 Fax

**APPROVED SHOP**

This sign will be  
Labeled ul or equal.

The installation  
Will meet national  
Electrical code  
Requirements

**REVISIONS**

**08-26-21**  
MAKE CHANGES PER  
CUSTOMERS NOTES

**09-01-21**  
MAKE CHANGES PER  
TM'S MARKED UP DWGS

**09-07-21**  
MAKE CHANGES PER  
CUSTOMERS MARKED  
UP PDF DWGS

**09-09-21**  
MAKE CHANGES PER  
CUSTOMERS MARKED  
UP PDF DWGS

**SIGNS AND  
LIGHTING  
LLC**